

**MADE IN
USA**

**With The Most Weight,
Highest Power Motors,
and Built to Last - Why
Look Anywhere Else?**

**Learn To Commercial
Clean, Prep, and
Maintain Floors the
EDGE way!**

**Anti-Vibration
Handle**



1

**Finished EDGE
Prepped**



**Square Head Allows
Corner Access**



5

2



Water Solution Tank

3

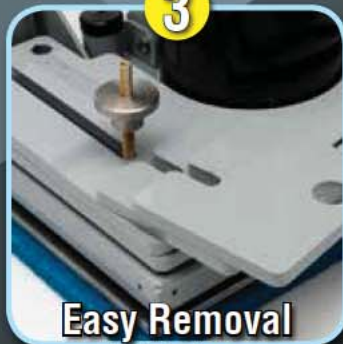

**Easy Removal
Weights**

4



Heavy Duty Isolators

**TOMCAT
EDGE**



Scan This QR
Code With
Your Phone
For More
Information

www.tomcatequip.com
1(800)450-9824
(+011) 262 681 6470

	EDGE-20ST	EDGE-20HD	EDGE-28HD
Body Construction / Dimensions			
Frame Material:	10 Gauge Steel (1/8") (3.57 mm)	10 Gauge Steel (1/8") (3.57 mm)	7 Gauge Steel (3/16") (4.76 mm)
Axle:	3/4" Solid Steel Axle (19.05 mm)	3/4" Solid Steel Axle (19.05 mm)	3/4" Solid Steel Axle (19.05 mm)
Handle Bar:	12 Gauge Steel, Adjustable (7/64") (2.78 mm)	12 Gauge Steel, Adjustable (7/64") (2.78 mm)	12 Gauge Steel, Adjustable (7/64") (2.78 mm)
Grips:	Padded	Padded	Padded
Finish:	Powder Paint	Powder Paint	Powder Paint
Wheels:	6" x 2" Non-Marking (15.25 x 5.08 cm)	6" x 2" Non-Marking (15.25 x 5.08 cm)	6" x 2" Non-Marking (15.25 x 5.08 cm)
Weight:	125 lbs (57 kg)	165 lbs (75 kg)	216 lbs (98 kg)
Extra Weights:	N/A	Removeable Weight Stack (Up to 329 lbs [149 kg])	Removeable Weight Stack (Up to 324 lbs [147 kg])

Brush / Pad System			
Dimensions:	20" x 14" (51 x 36 cm)	20" x 14" (51 x 36 cm)	28" x 14" (71 x 35 cm)
Motor Power:	1.5 hp	1.5 hp	1.5 hp
Motor RPM 60 hz:	1725 rpm	3450 rpm	3450 rpm
Motor RPM 50 hz:	N/A	2850 rpm	2850 rpm
Current Draw:	6.9 amps	6.9 amps	9.6 amps
Overload Guard:	Standard	Standard	Standard

Power System			
Voltage:	110V / 60 Hz	110V / 60 Hz 220V / 50-60 Hz	110V / 60 Hz 220V / 50-60 Hz
Cord Length:	50' (15.24 m)	50' (15.24 m)	50' (15.24 m)
Cord: Type	Domestic Cords: 14 AWG / Safety Yellow International Cords: 1.5mm ² Gauge Black	Domestic Cords: 14 AWG / Safety Yellow International Cords: 1.5mm ² Gauge Black	Domestic Cords: 14 AWG / Safety Yellow International Cords: 1.5mm ² Gauge Black
Plug:	Domestic: Hospital Grade Lighted International: CE Certified Country Specific Plug	Domestic: Hospital Grade Lighted International: CE Certified Country Specific Plug	Domestic: Hospital Grade Lighted International: CE Certified Country Specific Plug

General			
Cleaning Width:	20" (51 cm)	20" (51 cm)	28" (71 cm)
Productivity:	Up to 1,600 sqft/hr (149 sqm/hr)	Up to 1,600 sqft/hr (149 sqm/hr)	Up to 2,240 sqft/hr (208 sqm/hr)
Sound Level:	< 62 dBA	< 70 dBA	< 70 dBA
Hour Meter:	Optional (Dealer Install Only)	Standard	Standard
Dust Control:	Optional	Optional	Optional
Warranty:	1 Year	1 Year	1 Year
Motor Warranty:	2 Years (1,500 hrs)	2 Years (1,500 hrs)	2 Years (1,500 hrs)